

EXTEND THE FIELD OF SECURITY

MULTI DIMENSIONAL OUTDOOR DETECTOR

VX InfinityTM series

WIRED MODEL

VXI-ST : 12m flexible wide detection range
VXI-AM : ST with Anti-masking feature
VXI-DAM : ST with AM and Microwave technology

BATTERY OPERATED MODEL

VXI-R : Battery operated ST
VXI-RAM : Battery operated AM
VXI-RDAM : Battery operated DAM



Examples of Applicable Fields



Residential Environment



Warehouse



Power Station

Elvey is a leading distributor of electronic security equipment in Africa.

Our vision is to assist in the protection of people and property by providing quality, innovative products and solutions to the electronic security industry, thereby ensuring a safe and secure future for all.

ELVEY
Security Technologies

Providing Complete Peace of Mind
a division of Hudaco Trading (Pty) Ltd

MULTI DIMENSIONAL DETECTOR

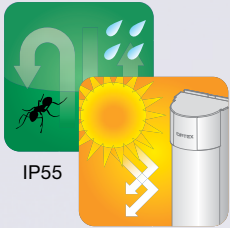

IP55

Anti UV Protection

Basic Performance ALL MODELS

- IP55
- Double Conductive Shielding
- Advanced Temperature Compensation Logic
- Utility Back Box
- Plug in EOL (End of Line) resistors ready (Wired model only)
- UV resistant ASA body.
- SMDA Logic for environmental noise immunity
- Vegetation Sway Analysis for Microwave
- N.C./N.O. Selectable Alarm output



Digital Analysis™

Double Layer Detection ALL MODELS



Both upper and lower detection area are blocked



Only lower detection area is blocked

POWER of FLEXIBILITY ALL MODELS

5 types of pre-cut masking seals included for optional configurations

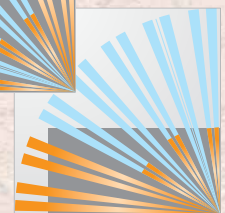
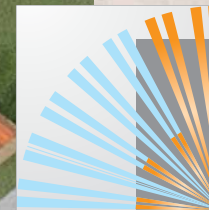
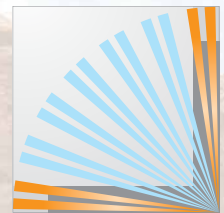
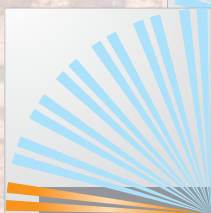
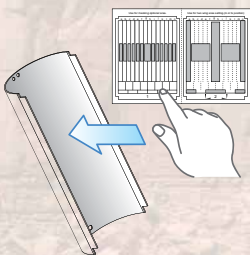

5 Levels of Detection Length Adjustment

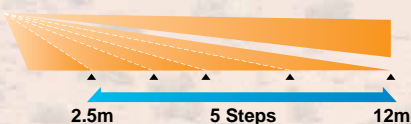
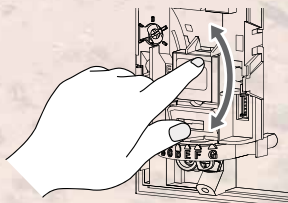

Adjust the PIR detection length by sliding the lower PIR to the desired position.

7 Positions of Horizontal Area Adjustments

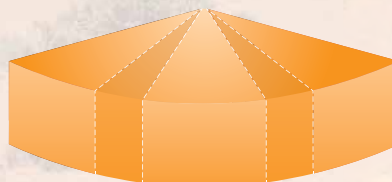
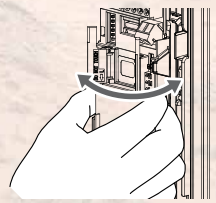

Various Mounting Capability



Wall Mount



Pole Mount



Utility Back Box



Metal Band Adaptable



WIRELESS READY

Battery Operation VXI-R, VXI-RAM, VXI-RDAM

Wireless ready "R-models" have a super low power consumption electrical circuit. OPTEX technology enabled not only IR Anti-Masking function but also Microwave Detection technology to be integrated into battery operated detectors.

Optional Accessory "RBB-01" accommodate extra batteries in VX-Infinity R-models providing extended operation life time.

Wireless Trigger Life Time*		
VXI	R, RAM	RDAM
CR123 (3VDC 1300mAh)	6 years	4 years
CR2 (3VDC 750mAh)	4 years	2 years

* Life Time calculation based on
LED:OFF, AM:ON, Battery Saving Timer:120sec



Active IR Digital Anti-Masking Function VXI-AM, VXI-DAM VXI-RAM, VXI-RDAM

When an object is placed on the lens surface, the IR anti-masking circuit will generate a trouble signal

Disarm



Sabotaged



Trouble out



Microwave Detection Assurance VXI-DAM VXI-RDAM

In the toughest outdoor environment, against a harsh light of a sunrise or a sudden strobe flash from a vehicle in a distance, Microwave equipped D models ensure stable operation with minimized false alarms.

Tough Mod.2 enables VXI series to take the advantages of Microwave into a battery operation.

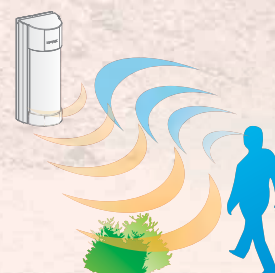

OPTIONS

VXI-T-Bracket

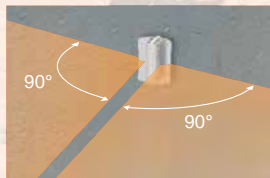

Applicable to ST, AM, R, RAM only

Battery Box

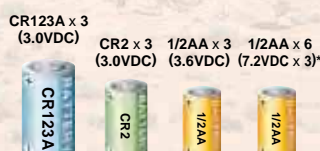

*3.6 VDC 1/2 AA battery in series.

Applicable to R, RAM, RDAM only

Wall tamper (WRS-04)



Wall tamper (WRS-02)



DETECTION AREA

SIDE VIEW

Length limiting position 1 (Default)

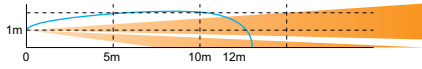

Length limiting position 2

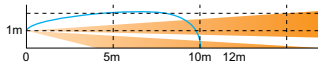

Length limiting position 3

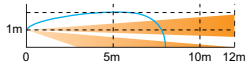

Length limiting position 4

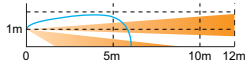

Length limiting position 5

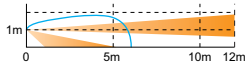

The maximum detection length may vary due to various thermal conditions of surroundings.

TOP VIEW

Area diagram of horizontal position D

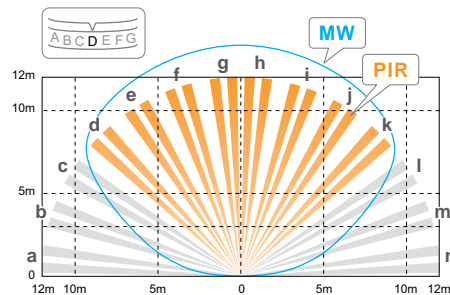

DIMENSIONS

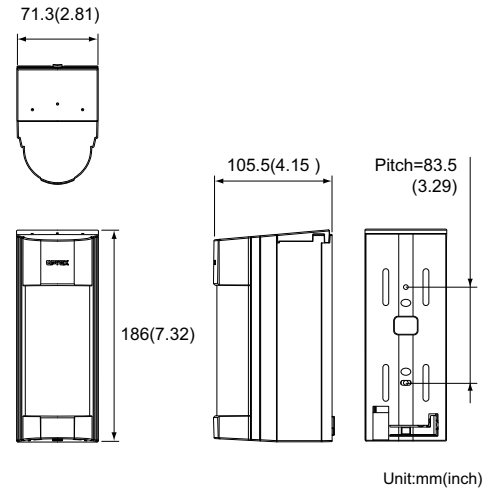

SPECIFICATIONS

Model	VXI-ST	VXI-AM	VXI-DAM
Detection Method	Passive infrared		Passive infrared & Microwave
PIR Coverage	12.0 m (40 ft) wide / 16 zones		
PIR Distance Limit	12 - 2.5 m (5 levels)		
Detectable Speed	0.3 - 1.5 m/s (1 - 5 ft/s)		
Sensitivity	2.0°C (3.6°F) at 0.6 m/s (2 ft/s)		
Power Input	9.5 - 18 V DC		
Current Draw	20 mA (max) at 12 V DC	24 mA (max) at 12 V DC	35 mA (max) at 12 V DC
Alarm Period	2.0 ± 1 sec.		
Warm-up Period	Approx. 60 sec. (LED blinks)		
Alarm Output	N.C. / N.O. Selectable 28 V DC 0.1 A (max)		
Trouble Output	N.C. 28 V DC 0.1 A (max)		
Tamper Output	N.C. 28 V DC 0.1 A (max) open when cover removed.		
LED Indicator	Red: Warm-up, alarm, masking detection (VXI-AM only)		Red: Warm-up, alarm, masking detection. Yellow: Warm-up, MW detect.
RF Interference	No alarm 10 V/m		
Operating Temperature	-30 - +60°C (-22 - +140°F)		-20 - +45°C (-4 - +113°F)
Environment Humidity	95% max.		
Weatherproof	IP55		
Mounting	Wall, Pole (Outdoor, Indoor)		
Mounting Height	0.8 - 1.2 m (2'7" - 3'9")		
Weight	500 g (17.7 oz.)		600 g (21.2 oz.)
Accessories	Screw (4x20 mm) x2, Wiring sponge x3, Masking seal x3		

Model	VXI-R	VXI-RAM	VXI-RDAM
Detection Method	Passive infrared		Passive infrared & Microwave
PIR Coverage	12.0 m (40 ft) wide / 16 zones		
PIR Distance Limit	12 - 2.5 m (5 levels)		
Detectable Speed	0.3 - 1.5 m/s (1 - 5 ft/s)		
Sensitivity	2.0°C (3.6°F) at 0.6 m/s (2 ft/s)		
Power Input	3 - 9 V DC (Lithium or Alkaline Battery)		
Current Draw	9µA (standby) / 4 mA (max) at 3 V DC	10µA (standby) / 4 mA (max) at 3 V DC	18µA (standby) / 8 mA (max) at 3 V DC
Alarm Period	2.0 ± 1 sec.		
Warm-up Period	Approx. 60 sec. (LED blinks)		
Alarm Output	N.C. / N.O. Selectable-Solid State Switch 10 V DC 0.01 A (max)		
Trouble Output	N.C. / N.O. Selectable-Solid State Switch 10 V DC 0.01 A (max)		
LED Indicator	Disable: During normal operation. Enable: During WALK TEST or LED SW on. Red: Warm-up, alarm, masking detection (VXI-RAM only)		Disable: During normal operation. Enable: During WALK TEST or LED SW on. Red: Warm-up, alarm, masking detection. Yellow: Warm-up, MW detect.
RF Interference	No alarm 10 V/m		
Operating Temperature	-20 - +60°C (-4 - +140°F)		-20 - +45°C (-4 - +113°F)
Environment Humidity	95% max.		
Weatherproof	IP55		
Mounting	Wall, Pole (Outdoor, Indoor)		
Mounting Height	0.8 - 1.2 m (2'7" - 3'9")		
Weight	500 g (17.7 oz.)		600 g (21.2 oz.)
Accessories	Connector for POWER and ALARM, Connector for TROUBLE, Screw (4x20mm) x2, Masking seal x3		

* Specifications and design are subject to change without prior notice.

Elvey is a leading distributor of electronic security equipment in Africa.

Our vision is to assist in the protection of people and property by providing quality, innovative products and solutions to the electronic security industry, thereby ensuring a safe and secure future for all.

ELVEY
Security Technologies

Providing Complete Peace of Mind

a division of Hudaco Trading (Pty) Ltd



+27 (0) 11 401 6700



+27 (0) 11 401 6753



info@elvey.co.za



www.elvey.co.za